

# GATE HOUSE FLOOR PLAN

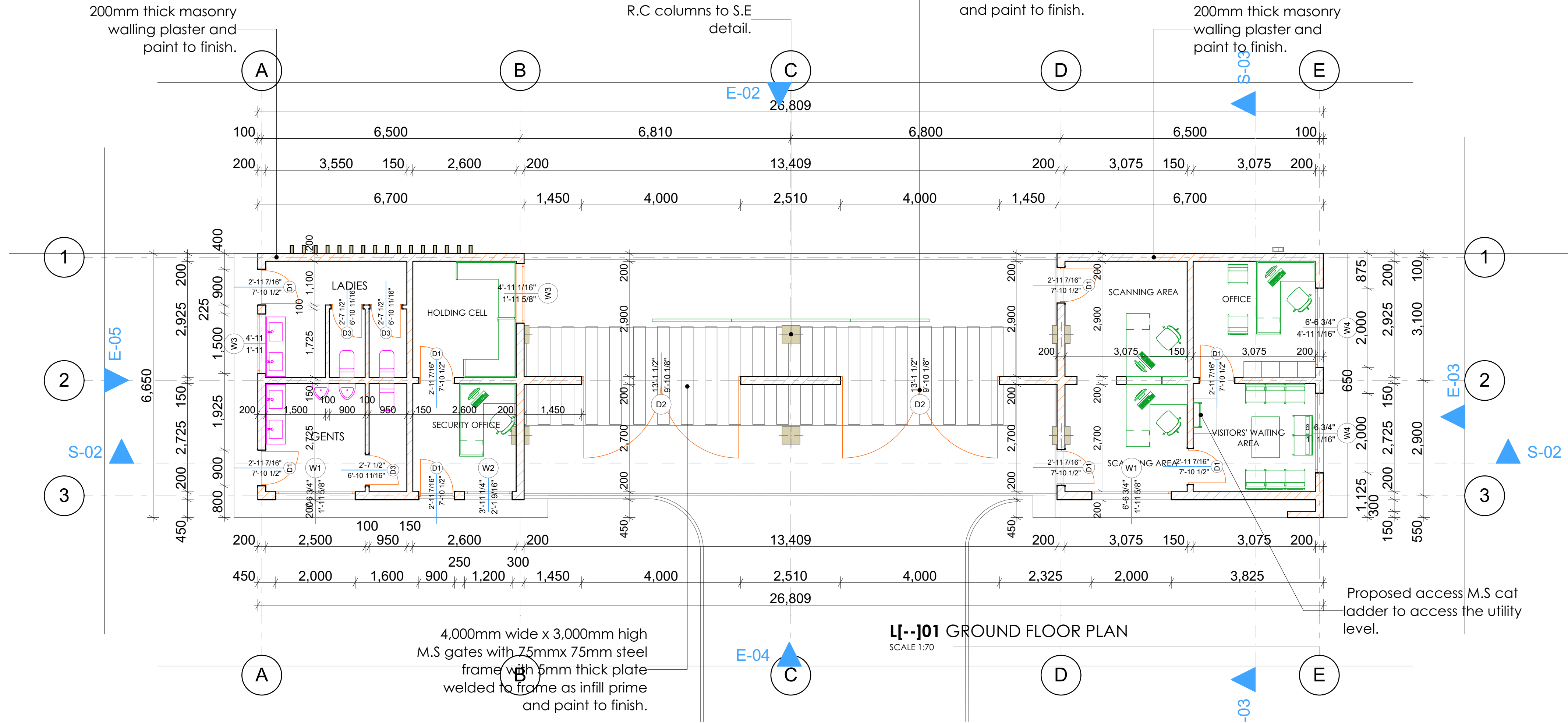

# GATE HOUSE ROOF PLAN

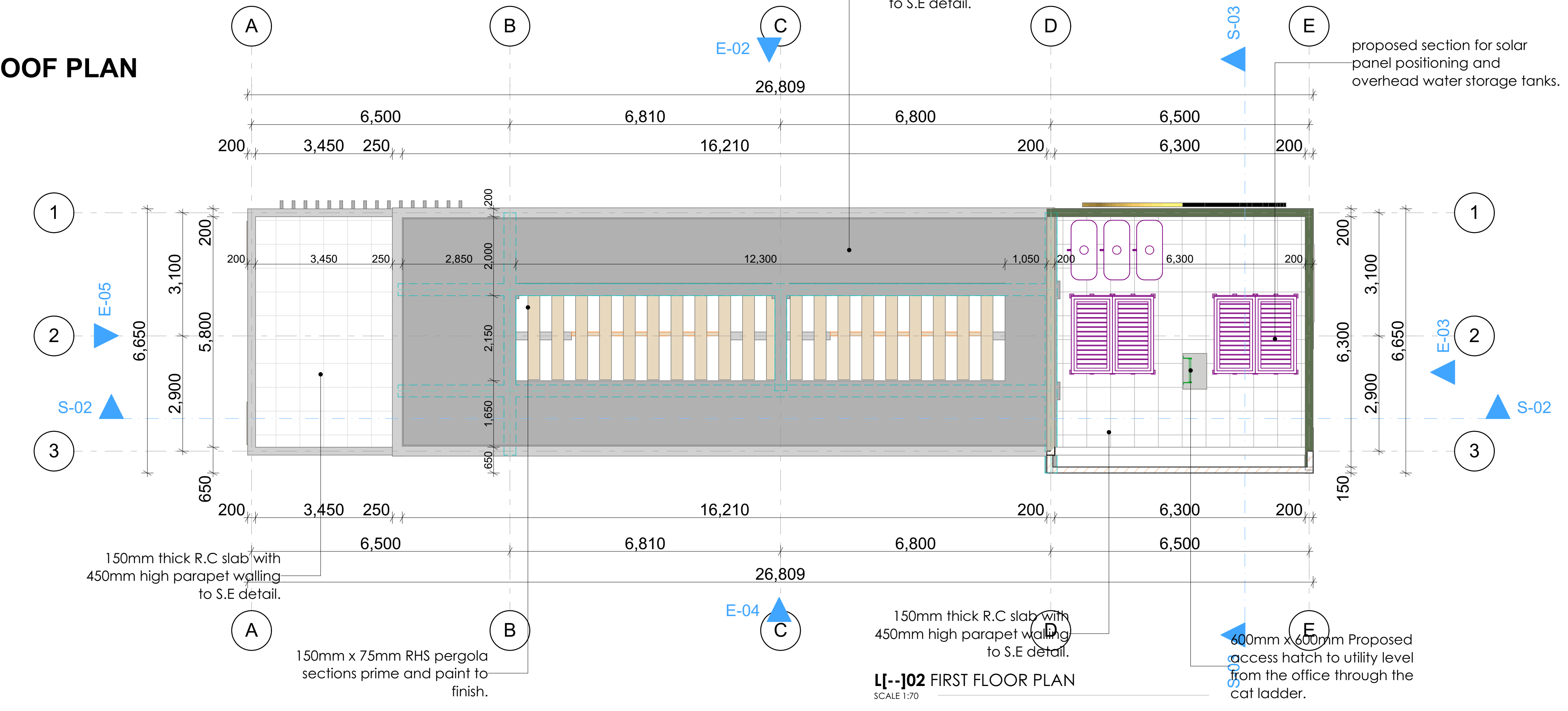

## NOTES

- General**  
This drawing is to be read in conjunction with engineer's drawings.  
All dimensions are in mm, unless otherwise specified.  
Drawings are not to be scaled, only figured dimensions to be used.  
The contractor must check & verify all the dimensions before commencement of the work.
- Construction**  
All slabs at ground level to be laid over 1,000 gauge polythene sheeting on 50mm thick murrum blinding, on well compacted hardcore.  
All soils under slabs & around external foundation to be treated for termites.
- Structural**  
All black cotton soil to be removed from below all building & paved surfaces.  
All paved surfaces to be clear of black cotton soil to a distance of 500mm outside the edge of the surface.  
For all R.C works, refer to Structural Engineer's details.  
Foundation depths to be determined on site, to the Structural Engineer's approval.  
All walls less than 200mm thick to be reinforced with hoop iron at every alternate course.  
All adjacent R.C work and masonry walls to be tied with strap irons at every course.
- Mechanical**  
All plumbing & drainage work to comply with P.H specifications.  
All surface ducts to be accessible from all floors.  
S.V.P denotes soil vent pipe and to be provided at the head of drainage.  
Drains passing underneath buildings and driveways to be encased in 150mm concrete surround.  
All underground foul & waste drain pipes shall be of PVC to comply with BS5255.  
All inspection chambers covers and framing shall be cast iron to comply with BS 497 Table 2 Grade A.  
The storm water drain pipes to comply with BS 556.  
Minimum slope in the drain pipes to be 1%.  
No chases for pipes will be allowed in the slabs.  
Sleeves will be allowed with written approval from the Structural Engineer.  
No cutting of concrete without express approval of the Architect or Structural Engineer.  
All testing of pipes must be coordinated with electrical & any conflicts must be clarified before work begins.  
P.V denotes permanent vents.
- Electrical**  
All conduits must be laid before plastering.
- Firefighting**  
Provide a 1,130 litres reserve tank with a booster pump.  
Dry risers.  
Provide a 1/30m hydraulic hose reel on every floor.  
Provide manual/electric break glass fire alarm system.  
Provide 40kg Litres CO2 fire extinguishers on every floor.

**Project:**  
Proposed Kenya Utalii College Kilgoris Campus

**Drawing Title:**  
Gate House and Perimeter Fence

**Client Ministry / Department:**  
Kenya Utalii College

**Client Signature:**

**Job No.**  
WP Item No: D1202/NRK/RV/2401  
Job No: 11426A

**Drawing No.** 01

**Drawn by:**  
Name:  
G.K  
Date & Sign:

**Designed by:**  
Name:  
  
Date & Sign:

**Checked by:**  
Name:  
  
Date & Sign:

**Chief Architect:**

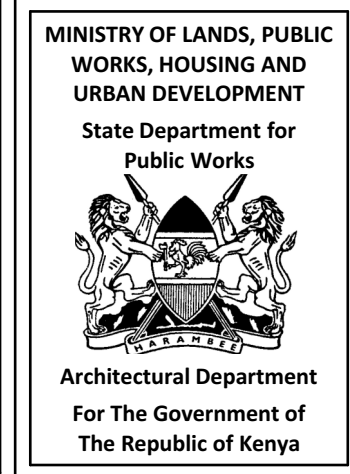

# GATE HOUSE ELEVATIONS & SECTIONS

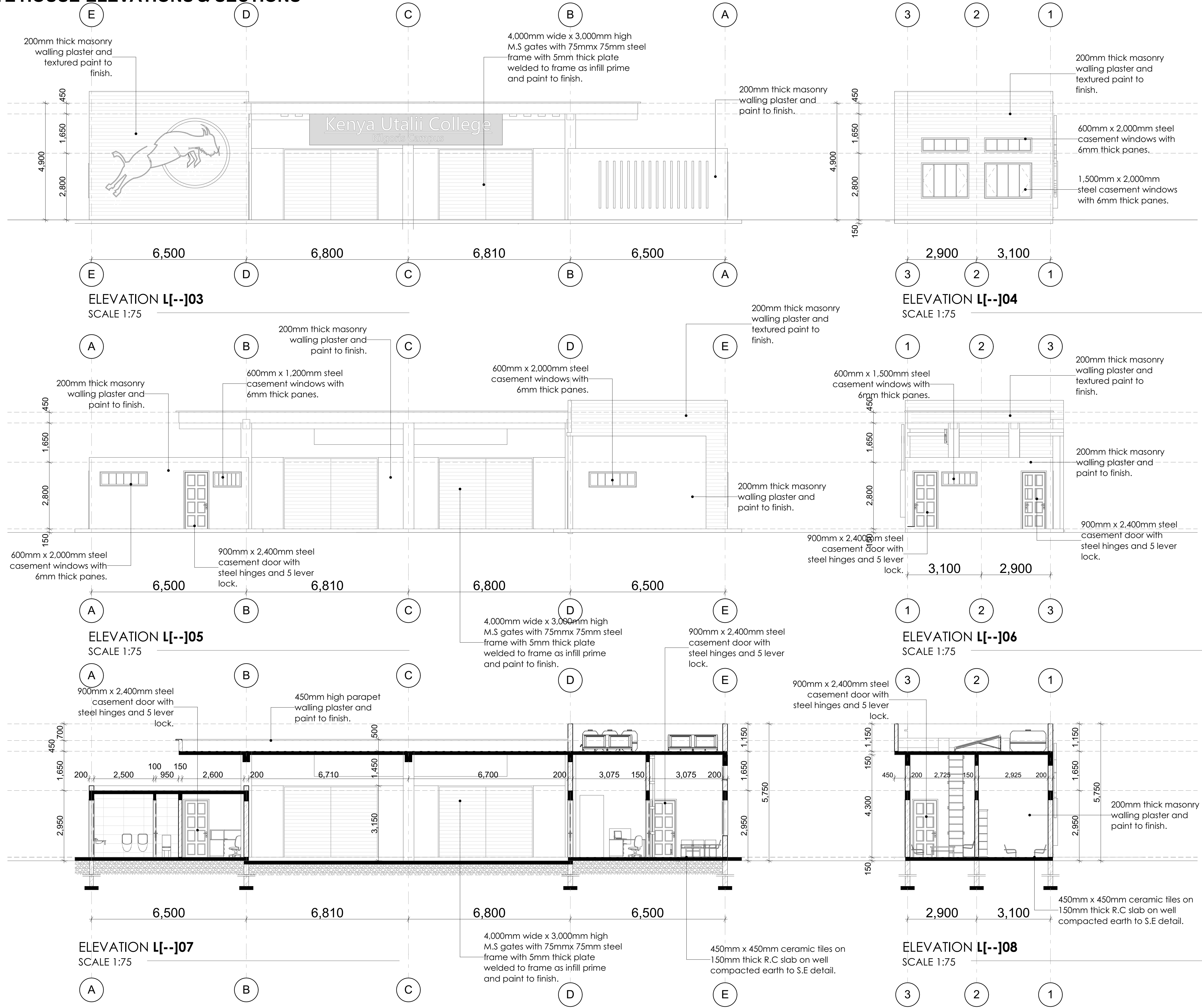

**NOTES**

**General**  
This drawing is to be read in conjunction with engineer's drawings.  
All dimensions are in mm, unless otherwise specified.  
Drawings are not to be scaled, only figured dimensions to be used.  
The contractor must check & verify all the dimensions before commencement of the work.

**Construction**  
All slabs at ground level to be laid over 1,000 gauge polythene sheeting on 50mm thick murrum blinding, on well compacted hardcore.  
All soils under slabs & around external foundation to be treated for termites.

**Structural**  
All black cotton soil to be removed from below all building & paved surfaces.  
All paved surfaces to be clear of black cotton soil to a distance of 500mm outside the edge of the surface.  
For all R.C works, refer to Structural Engineer's details.  
Foundation depths to be determined on site, to the Structural Engineer's approval.  
All walls less than 200mm thick to be reinforced with hoop iron at every alternate course.  
All adjacent R.C work and masonry walls to be tied with strap irons at every course.

**Mechanical**  
All plumbing & drainage work to comply with P.H specifications.  
All surface ducts to be accessible from all floors.  
S.V.P denotes soil vent pipe and to be provided at the head of drainage.  
Drains passing underneath buildings and driveways to be encased in 150mm concrete surround.  
All underground foul & waste drain pipes shall be of PVC to comply with BS5255.  
All inspection chambers covers and framing shall be cast iron to comply with BS 497 Table 2 Grade A.  
The storm water drain pipes to comply with BS 556.  
Minimum slope in the drain pipes to be 1%.  
No chases for pipes will be allowed in the slabs.  
Sleeves will be allowed with written approval from the Structural Engineer.  
No cutting of concrete without express approval of the Architect or Structural Engineer.  
All testing of pipes must be coordinated with electrical & any conflicts must be clarified before work begins.  
P.V denotes permanent vents.

**Electrical**  
All conduits must be laid before plastering.

**Firefighting**  
Provide a 1,130 Litres reserve tank with a booster pump.  
Dry risers.  
Provide a 130m hydraulic hose reel on every floor.  
Provide manual/electric break glass fire alarm system.  
Provide 40kg Litres CO2 fire extinguishers on every floor.

**Project:**  
Proposed Kenya Utalii College Kilgoris Campus

**Drawing Title:**  
Gate House and Perimeter Fence

**Client Ministry / Department:**  
Kenya Utalii College

**Client Signature:**

**Job No.**  
WP Item No: D1202/NRK/RV/2401  
Job No: 11426A

**Drawing No.** 02

**Drawn by:**  
Name:  
G.K  
Date & Sign:

**Designed by:**  
Name:

Date & Sign:

**Checked by:**  
Name:

Date & Sign:

**Chief Architect:**

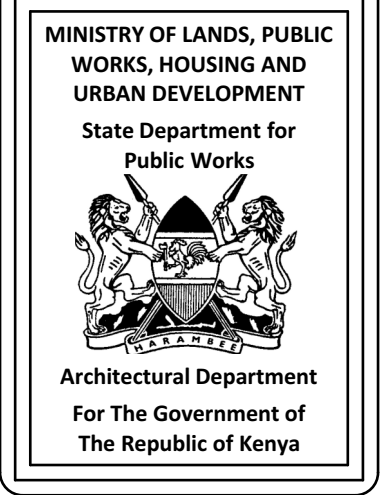



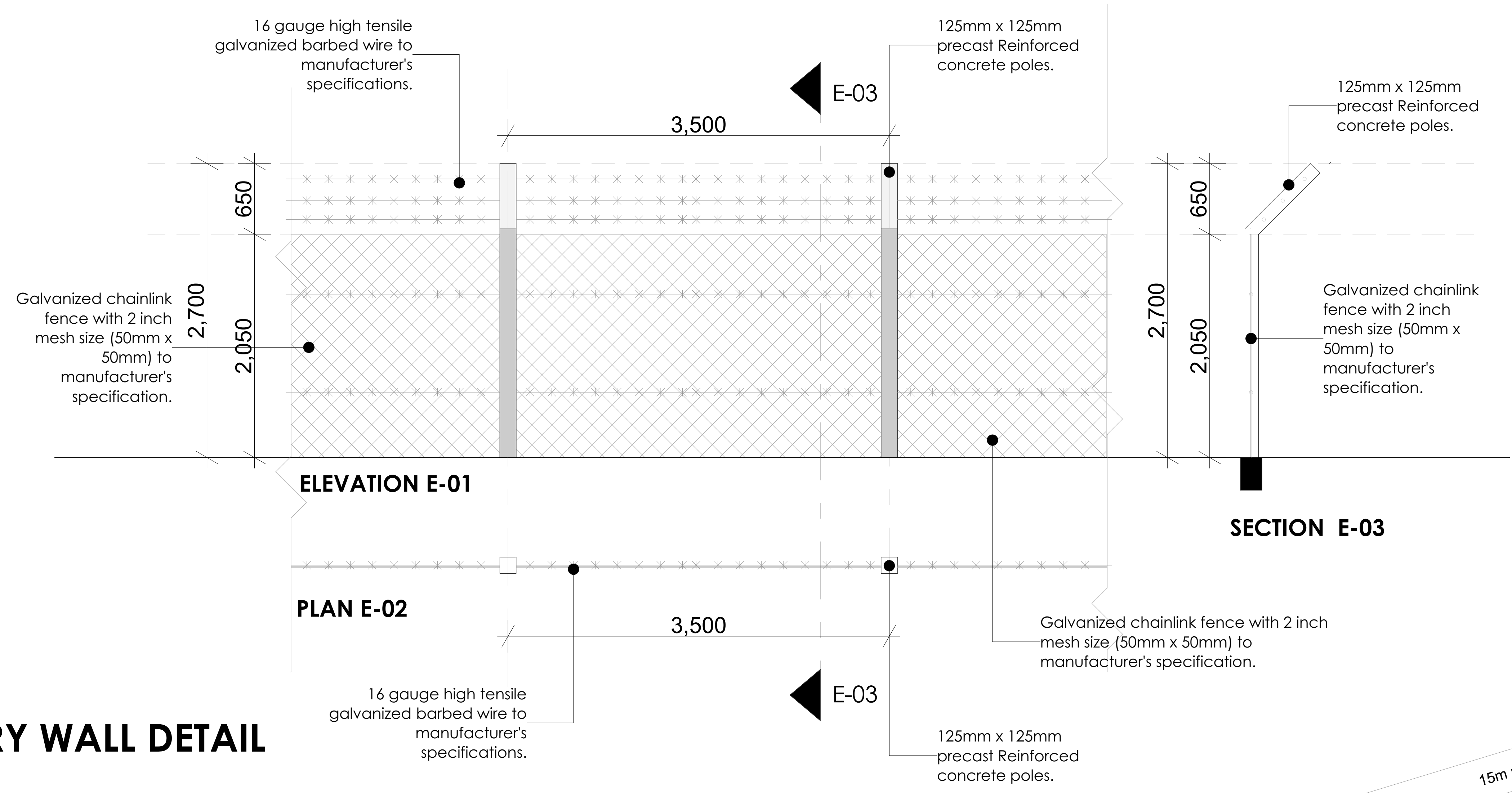

# BOUNDARY WALL DETAIL

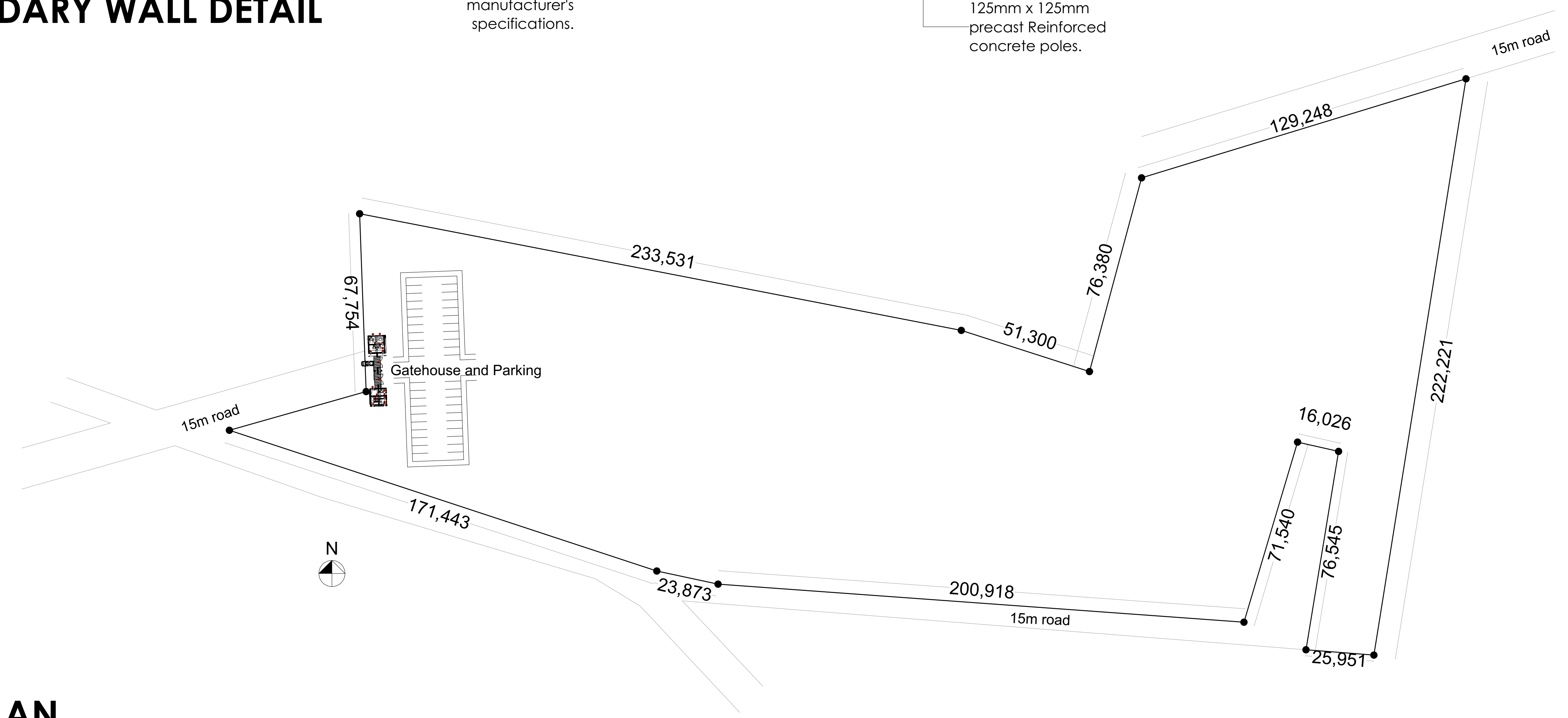

# SITE PLAN

### NOTES

- General**  
This drawing is to be read in conjunction with engineer's drawings.  
All dimensions are in mm, unless otherwise specified.  
Drawings are not to be scaled, only figured dimensions to be used.  
The contractor must check & verify all the dimensions before commencement of the work.
- Construction**  
All slabs at ground level to be laid over 1,000 gauge polythene sheeting on 50mm thick murrum blinding, on well compacted hardcore.  
All soils under slabs & around external foundation to be treated for termites.
- Structural**  
All black cotton soil to be removed from below all building & paved surfaces.  
All paved surfaces to be clear of black cotton soil to a distance of 500mm outside the edge of the surface.  
For all R.C works, refer to Structural Engineer's details.  
Foundation depths to be determined on site, to the Structural Engineer's approval.  
All walls less than 200mm thick to be reinforced with hoop iron at every alternate course.  
All adjacent R.C work and masonry walls to be tied with strap irons at every course.
- Mechanical**  
All plumbing & drainage work to comply with P.H specifications.  
All surface ducts to be accessible from all floors.  
S.V.P denotes soil vent pipe and to be provided at the head of drainage.  
Drains passing underneath buildings and driveways to be encased in 150mm concrete surround.  
All underground foul & waste drain pipes shall be of PVC to comply with BS5255.  
All inspection chambers covers and framing shall be cast iron to comply with BS 497 Table 2 Grade A.  
The storm water drain pipes to comply with BS 556.  
Minimum slope in the drain pipes to be 1%.  
No chases for pipes will be allowed in the slabs.  
Sleeves will be allowed with written approval from the Structural Engineer.  
No cutting of concrete without express approval of the Architect or Structural Engineer.  
All testing of pipes must be coordinated with electrical & any conflicts must be clarified before work begins.  
P.V denotes permanent vents.
- Electrical**  
All conduits must be laid before plastering.
- Firefighting**  
Provide a 1,130 Litres reserve tank with a booster pump.  
Dry risers  
Provide a 1x30m hydraulic hose-reel on every floor.  
Provide manual/electric break glass fire alarm system.  
Provide 40kg Litres CO2 fire extinguishers on every floor.

**Project:**  
Proposed Kenya Utalii College Kilgoris Campus

**Drawing Title:**  
Gate House and Perimeter Fence

**Client Ministry / Department:**  
Kenya Utalii College

**Client Signature:**

**Job No.**  
WP Item No: D1202/NRK/RV/2401  
Job No: 11426A

**Drawing No.** 03

**Drawn by:**  
Name:  
G.K  
Date & Sign:

**Designed by:**  
Name:  
  
Date & Sign:

**Checked by:**  
Name:  
  
Date & Sign:

**Chief Architect:**

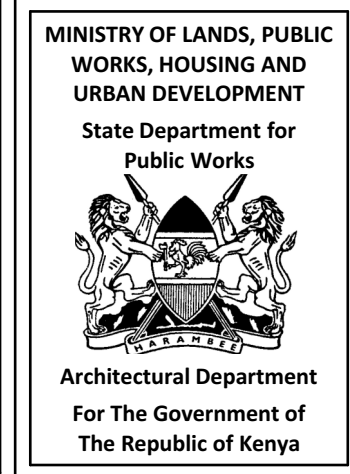

# OPENING SCHEDULE

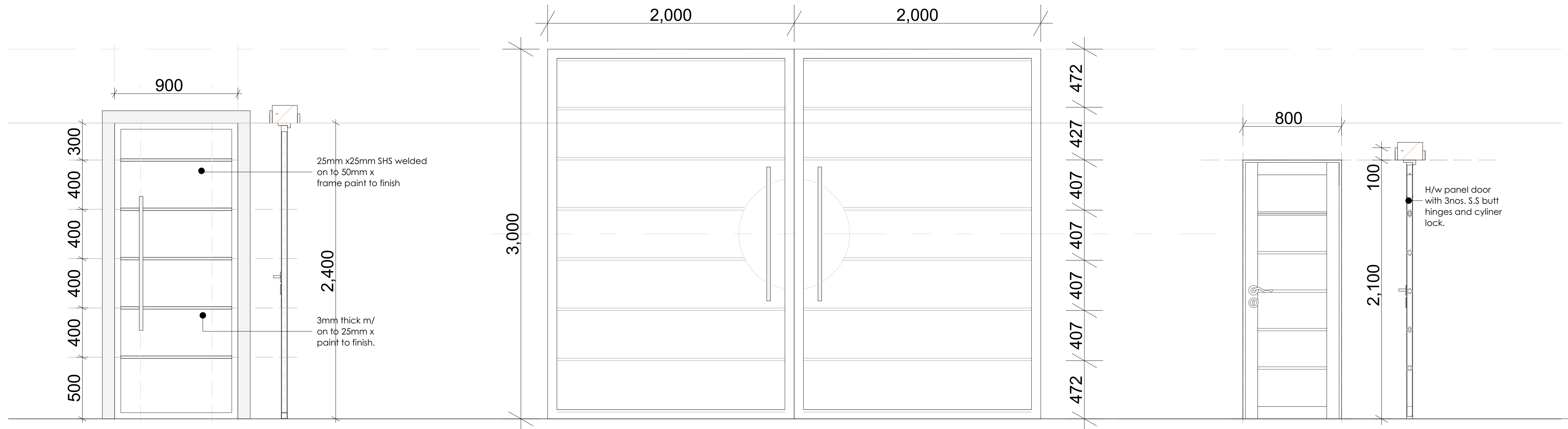

**D1**  
**C{32}01**  
**Location:** Offices.  
**Quantity:** 8 nos.  
**Material:** Steel casement door with SHS frame, 3 nos. hinges and 3 lever lock with 30mm dia x 1,000mm CHS door handle prime and paint to finish.

**D2**  
**C{32}02**  
**Location:** main gate.  
**Quantity:** 2 nos.  
**Material:** Steel casement gate with SHS frame, 3 nos. hinges and lock with 30mm dia x 1,000mm CHS door handle prime and paint to finish.

**D3**  
**C{32}03**  
**Location:** Toilet cubicles.  
**Quantity:** 3 nos.  
**Material:** Semi Solid core flush door with panel door veneer facing, 3 lever lock, 3 nos. S.S butt hinges and brass door handles to approval.

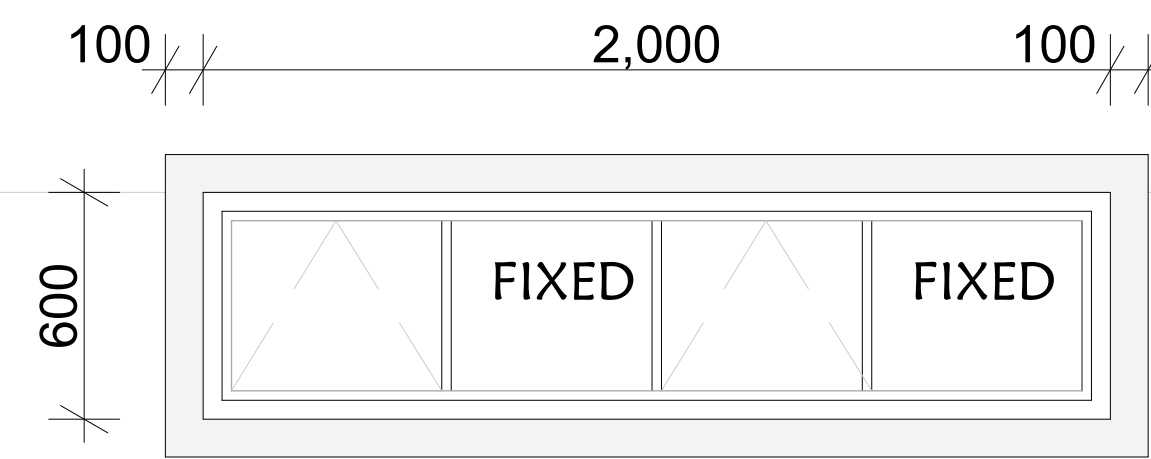

**W1**  
**C{33}01**  
**Location:** washrooms  
**Quantity:** 4 nos.  
**Material:** Steel casement frame with 6mm thick sheet glass with 100mm x 25mm thick plaster band paint to finish.

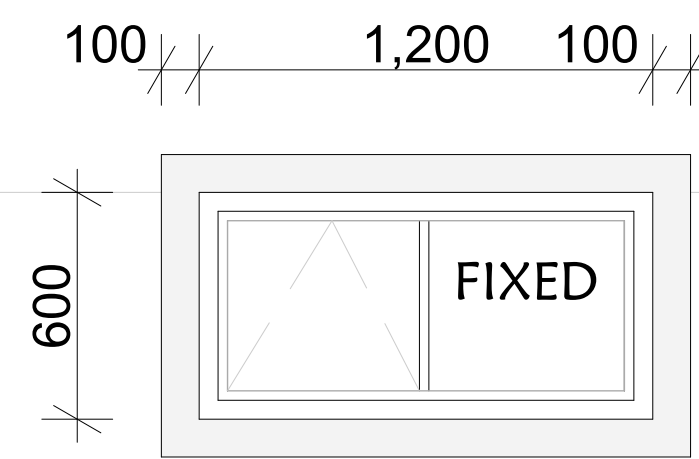

**W2**  
**C{33}02**  
**Location:** washrooms  
**Quantity:** 1 no.  
**Material:** Steel casement frame with 6mm thick sheet glass with 100mm x 25mm thick plaster band paint to finish.

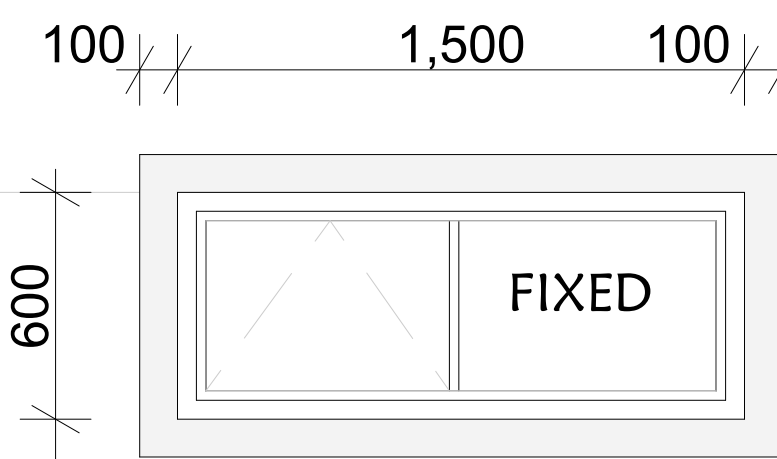

**W3**  
**C{33}03**  
**Location:** washrooms  
**Quantity:** 2 nos.  
**Material:** Steel casement frame with 6mm thick sheet glass with 100mm x 25mm thick plaster band paint to finish.

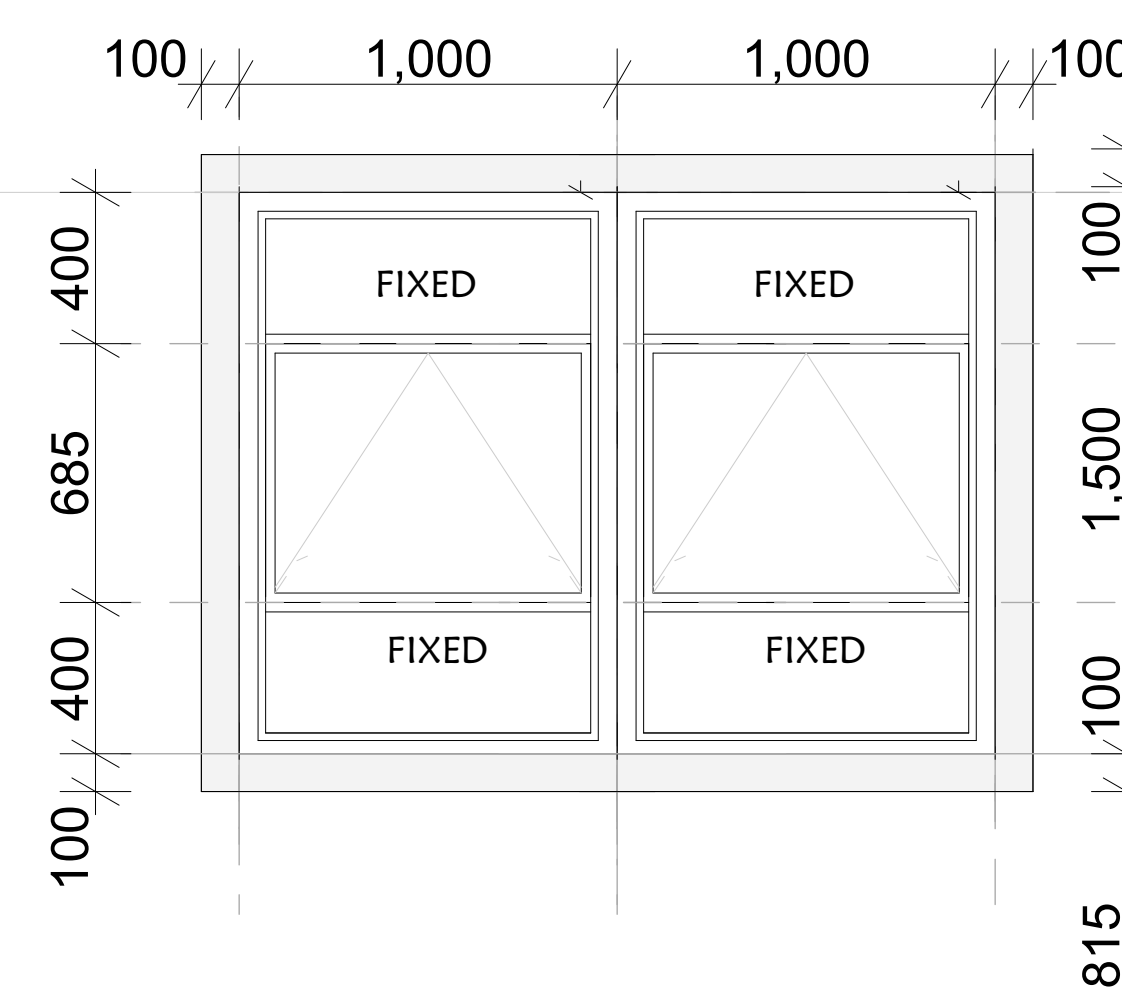

**W4**  
**C{33}04**  
**Location:** offices  
**Quantity:** 2nos.  
**Material:** Steel casement frame with 6mm thick sheet glass with 100mm x 25mm thick plaster band paint to finish.

## NOTES

**General**  
 This drawing is to be read in conjunction with engineer's drawings.  
 All dimensions are in mm, unless otherwise specified.  
 Drawings are not to be scaled, only figured dimensions to be used.  
 The contractor must check & verify all the dimensions before commencement of the work.

**Construction**  
 All slabs at ground level to be laid over 1,000 gauge polythene sheeting on 50mm thick murrum blinding, on well compacted hardcore.  
 All soils under slabs & around external foundation to be treated for termites.

**Structural**  
 All black cotton soil to be removed from below all building & paved surfaces.  
 All paved surfaces to be clear of black cotton soil to a distance of 500mm outside the edge of the surface.  
 For all R.C works, refer to Structural Engineer's details.  
 Foundation depths to be determined on site, to the Structural Engineer's approval.  
 All walls less than 200mm thick to be reinforced with hoop iron at every alternate course.  
 All adjacent R.C work and masonry walls to be tied with strap irons at every course.

**Mechanical**  
 All plumbing & drainage work to comply with P.H specifications.  
 All surface ducts to be accessible from all floors.  
 S.V.P denotes soil vent pipe and to be provided at the head of drainage.  
 Drains passing underneath buildings and driveways to be encased in 150mm concrete surround.  
 All underground foul & waste drain pipes shall be of PVC to comply with BS5255.  
 All inspection chambers covers and framing shall be cast iron to comply with BS 497 Table 2 Grade A.  
 The storm water drain pipes to comply with BS 556.  
 Minimum slope in the drain pipes to be 1%.  
 No chases for pipes will be allowed in the slabs.  
 Sleeves will be allowed with written approval from the Structural Engineer.  
 No cutting of concrete without express approval of the Architect or Structural Engineer.  
 All testing of pipes must be coordinated with electrical & any conflicts must be clarified before work begins.  
 P.V denotes permanent vents.

**Electrical**  
 All conduits must be laid before plastering.

**Firefighting**  
 Provide a 1,130 Litres reserve tank with a booster pump.  
 Dry risers  
 Provide a 1x30m hydraulic hose-reel on every floor.  
 Provide manual/electric break glass fire alarm system.  
 Provide 40kg Litres CO2 fire extinguishers on every floor.

**Project:**  
 Proposed Kenya Utalii College Kilgoris Campus

**Drawing Title:**  
 Gate House and Perimeter Fence

**Client Ministry / Department:**  
 Kenya Utalii College

**Client Signature:**

**Job No.**  
 WP Item No: D1202/NRK/RV/2401  
 Job No: 11426A

**Drawing No.** 04

**Drawn by:**  
 Name:  
 G.K  
 Date & Sign:

**Designed by:**  
 Name:  
 Date & Sign:

**Checked by:**  
 Name:  
 Date & Sign:

**Chief Architect:**